

# ROTARY EXR DISCONNECT INSTALLATION



Your Enclosure Source®



NEMA 3R, 4 & 12

## THE INTENT & PURPOSE OF THE EXR ENCLOSURE IS:

- 1) Isolate the primary power supply.
- 2) Initiate appropriate PPE for entry.
- 3) Prevent unauthorized entry, disconnect power before entry, and requiring the primary door latch or handle to be closed, latched, and engaged before the disconnect is restored.

### SCE-EXR12-30T200

Provisions for Compact Fusible Disconnect with Rotary handle Disconnect 30 to 200 amps Allen-Bradley 194R, Square D GS2, Eaton/Bussmann R9, Siemens CFS models and Socomec Fuserbloc models. Provides protection from dirt, dust, oil and water.

### SCE-EXR18-400

Provisions for Compact Fusible Disconnect with Rotary handle 400+ amps Allen-Bradley 194R, Square D GS2, Eaton/Bussmann R9, Siemens CFS models and Socomec Fuserbloc models. Provides protection from dirt, dust, oil and water.



See for modifications required for some Allen-Bradley Operating Handles

For installation of an EXR to a Free Standing Enclosure (Disconnect Enclosure) the following tools will be required:

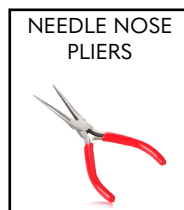

- First drill the mounting pattern into the right side of the main enclosure.
- Next use the disconnect cover plate to line up clearance hole drilling location for quarter turn.
- Disconnect cover plate, quarter turn, and nuts will connect to the upper assembly and hold it in place.



- Apply gasket to the left side of the EXR enclosure outside the holes to ensure a proper seal.
- Use 128550 master bolt pack to install EXR to the main enclosure.

**Note:** Keyway cutout on mounting provisions to ease installation.



<b>⚠ WARNING</b>	
	<p><b>Electrical shock and flash hazards</b>  <b>Appropriate PPE required</b></p> <p><u>Read and follow all instructions</u></p> <ul style="list-style-type: none"> <li>• Close and latch this door first</li> <li>• Close and fully latch all doors before power is restored</li> <li>• Disconnect power before opening this door</li> </ul>
<b>⚠ CLOSE AND LATCH THIS DOOR FIRST ⚠</b>	

Label part number 130130

**WITH THE EXR NOW INSTALLED ONTO THE MAIN ENCLOSURE, THE INTERLOCK CAN NOW BE INSTALLED**

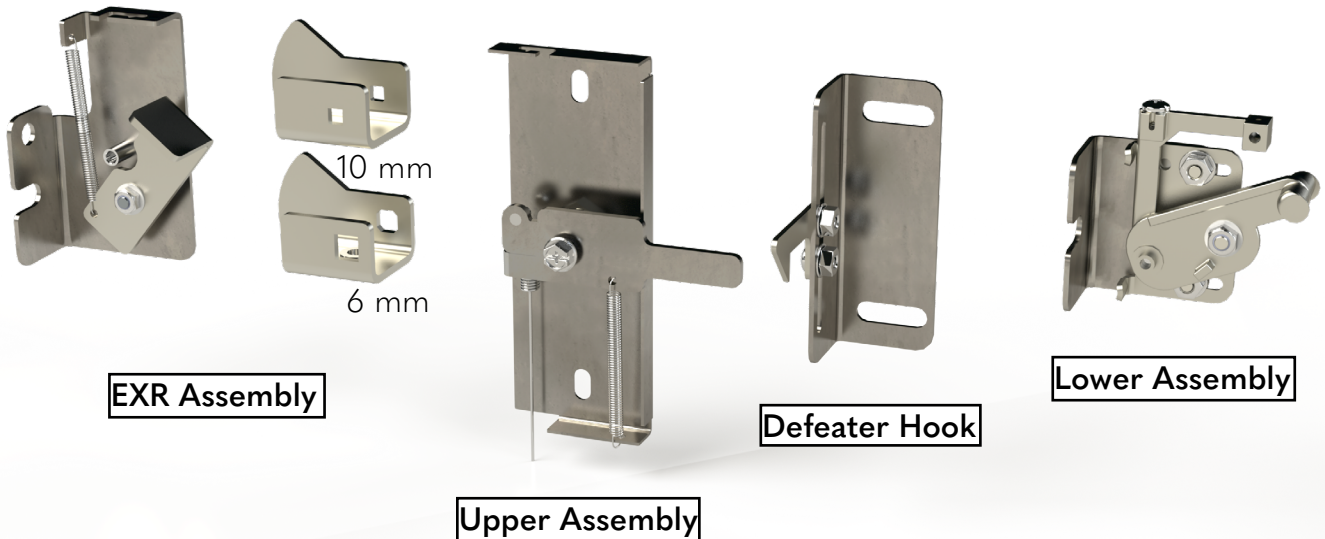

**MECHANICAL INTERLOCK AND DEFEATER KIT INCLUDED**

**ATTACH EXR ASSEMBLY**

- Attach EXR assembly to stud on inside wall of EXR.
- Install Defeater cable and crimp to lock into place as shown in "Detail C"

**DETAIL C**

Unlocked

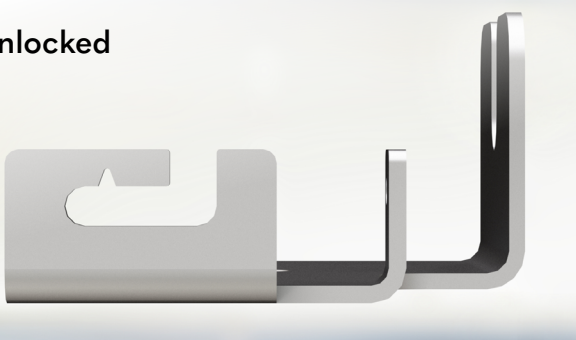

Locked

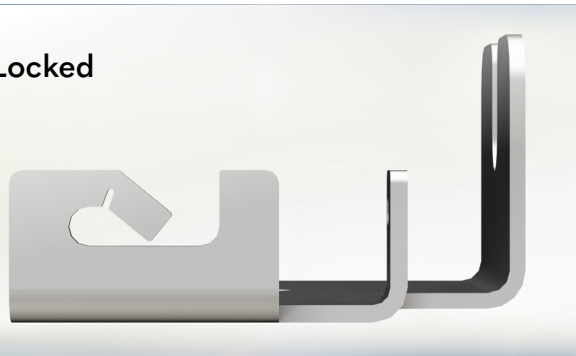

Standard Option



Allen Bradely NFA70 Option



## ATTACH UPPER ASSEMBLY

- Using the PEMs from the disconnect cover plate. Attach the EXR mechanical defeater rod guide with keps nuts.
- Insert quarter turn from outside of enclosure with earth nut.
- Attach EXR disconnect hook arm to quarter turn.
- Install cable and lock into place. Refer: Detail **C** above.



**UPPER ASSEMBLY  
(SHOWING DOOR COMPONENTS)**

## ADJUST THE MDV TO YOUR FLANGE SIZE

- A-** 3.50 inch flange is found on freestanding enclosures that are 3 doors and larger. Remove the 8-32 nuts, position at the outer holes.
- B-** 3.00 inch flange is found on most freestanding enclosures and is the preset location.
- Install assembly 3 of the MDV kit with 1/4-20 nut on the stud adjacent to the door handle. Slide it all the way to the flange and tighten.
- Now adjust the MDV. With the disconnect operating handle still in the “off” position, simply pull the cable down so that the defeater strike is horizontal.
- Then tighten the screw to lock in position.



**LOWER ASSEMBLY**



- Install Disconnect according to Disconnect Manufactures Installation Instructions.

- With the EXR assembly in the "on" position verify the main enclosure door engages the hook and prevents the door from opening.



- Cut rod to length and install

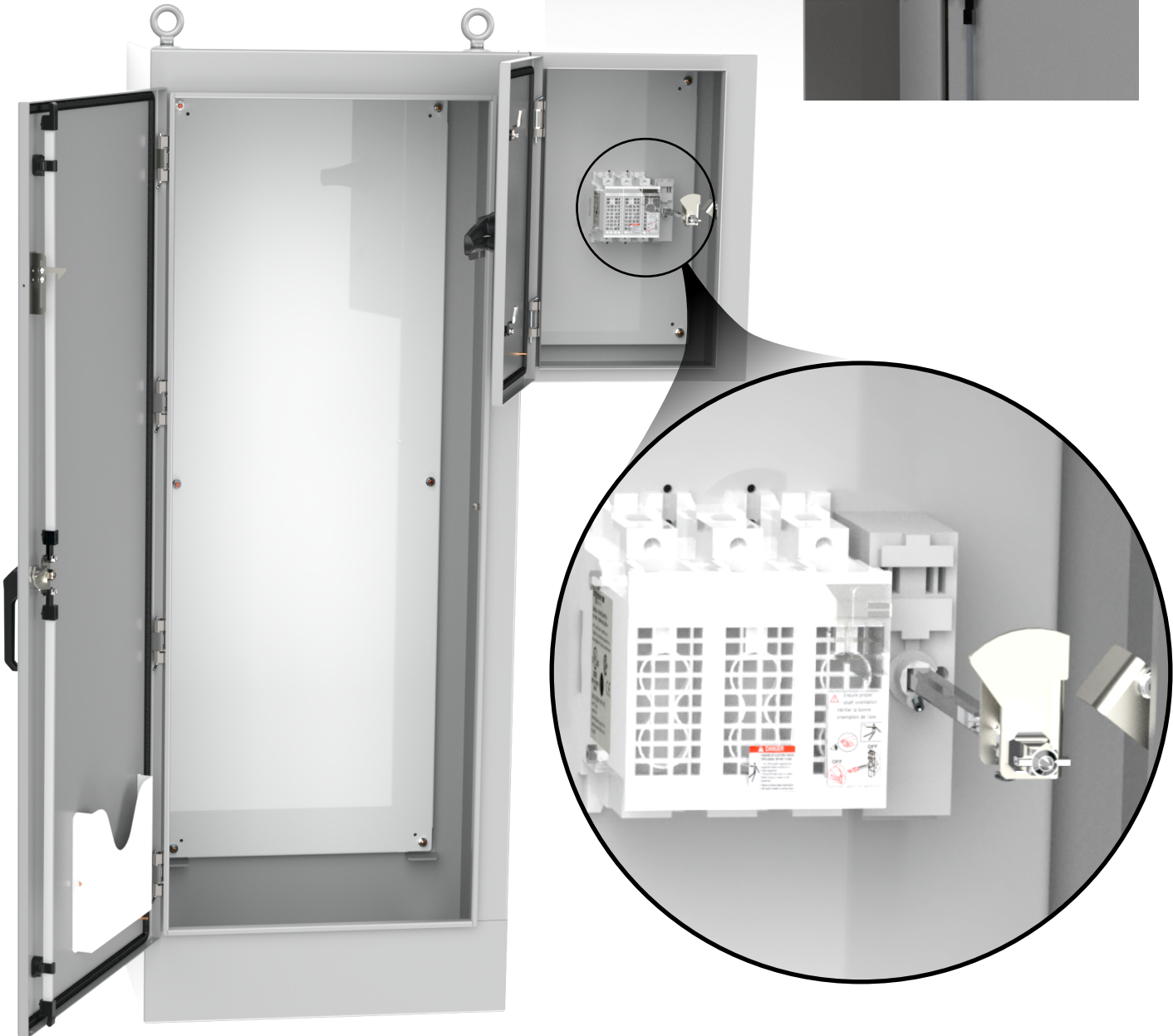

# CUTOUT DETAIL MODIFICATIONS

Do not scale

## STANDARD CUTOUT

### ALLEN-BRADLEY

Catalog Number

194R-HM4-L

-HM4E-L

-HM4-N2-L

-HM4E-N2-L

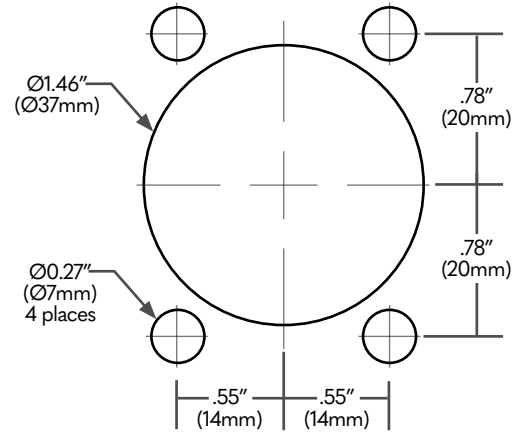

## ALLEN-BRADLEY

Catalog Number

194R-P...

140U-P...

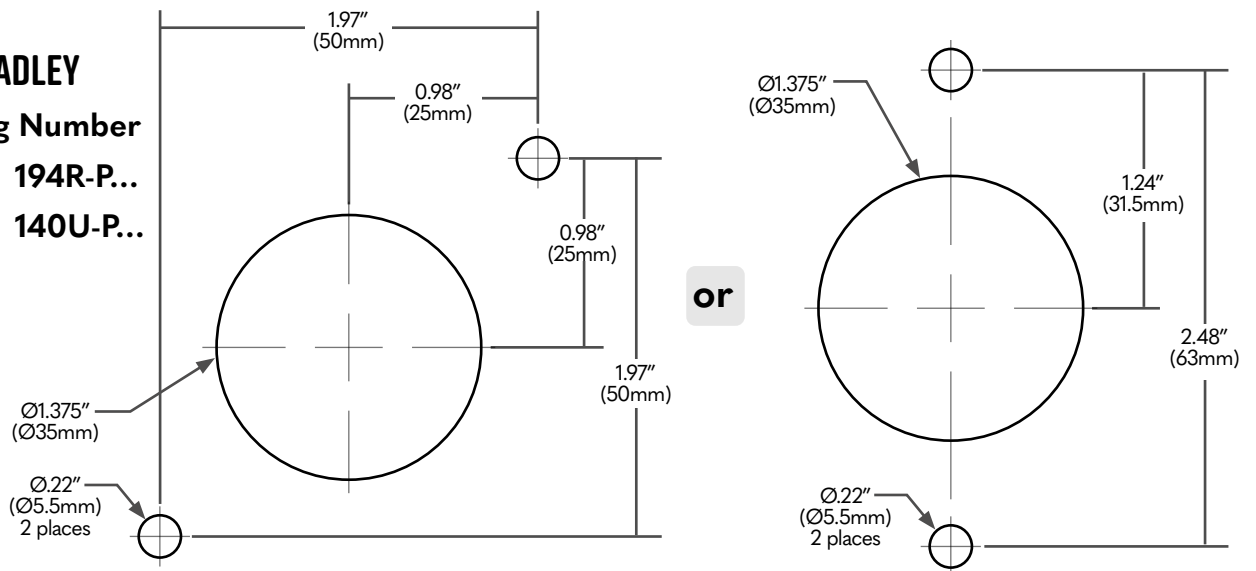

## ALLEN-BRADLEY 400 AMP

Catalog Number

194R-HM4

-HM4E

