

# SCE-3PTL 3-Point Latch kit

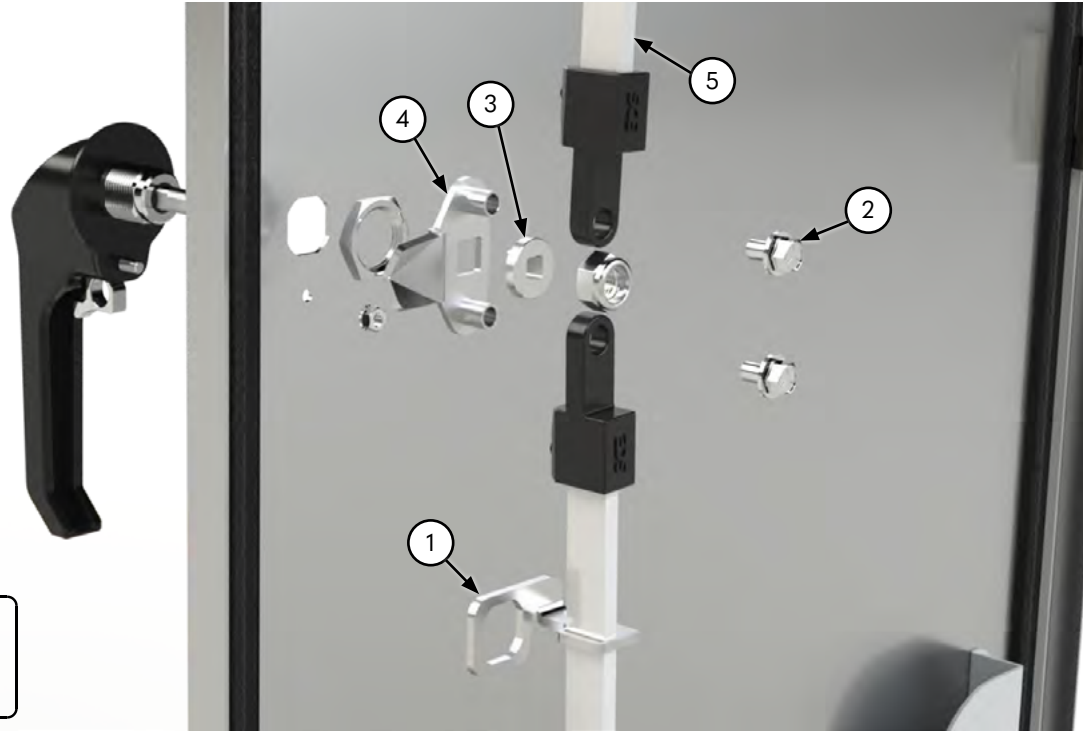

Your Enclosure Source®

Item	Qty	Bill of material SCE-3PTL	Part I.D.
1	2	Rod Guide, 1/4 Turn Mtg. Guide For 0.25 x 0.63 Door Rod, Steel, Zinc	102253
2	2	Bolt, Hex Head, Serrated Flange, 1/4-20 x 3/8", Steel, Zinc Clear Plated	112504
3	1	Door Center Adapter with Stop, 0.79 x 0.25, Zinc Die Cast	116470
4	1	Cam, 3 Point, Dual, Small Door Center with BSO's, Steel, Zinc Clear	128142
5	2	Door Rod Assembly, 37.00 in. Precut Rod, 39.33 in. Assembled	128208

## INSTALLATION INSTRUCTIONS:

- A. Cut and assemble door rod assembly by following instructions on page 2.
- B. Remove the mounting nuts from the quarter turn latches.
- C. Insert door rod (5) through the rod guide (1).
- D. Insert the rod guide onto quarter turn latch and resecure mounting nut.  
See quarter turn assembly view
- E. Complete door rod assembly by installing ramp shoe (7), adapter (8) and set screws (6).
- F. Install center door handle or latch and install the 3-point cam (4).
- G. Install the door rod adapters onto cam and tighten hex head bolts (2).

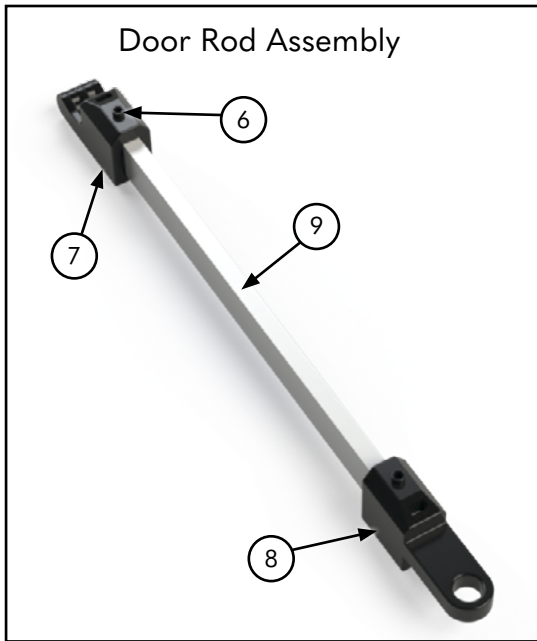

Item	Qty	Door Rod Assembly Part Description	Part I.D.
6	2	Screw, Set, Socket Head, Cone Point	102482
7	1	Door Rod Ramp Shoe	128145
8	1	Door Rod Adapter	128146
9	1	Flat Bar, Aluminum	128209

**Cut door rod length**

Door rod cut length = distance to opening - 2.13"  
 Door rod assembly length = door rod cut length + 2.33"

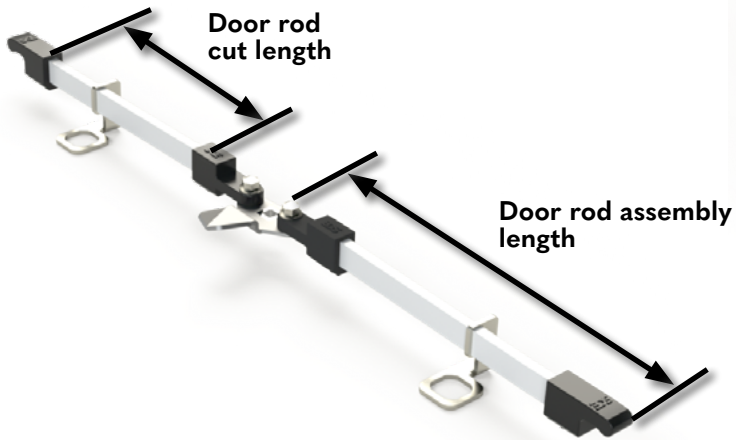

Along with any quarter turn latch, the following handles may be used with SCE-3PTL hardware.  
Handle to be ordered separately.