

DRILL THRU
Ø0.218 (x4)

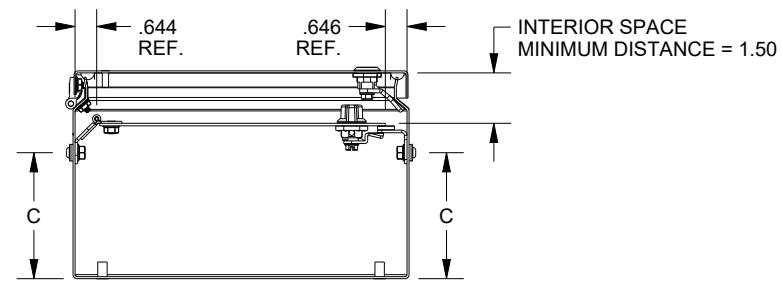

SECTION X-X

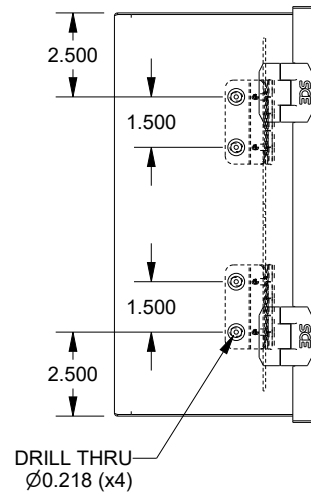

DRILL THRU
Ø0.218 (x4)

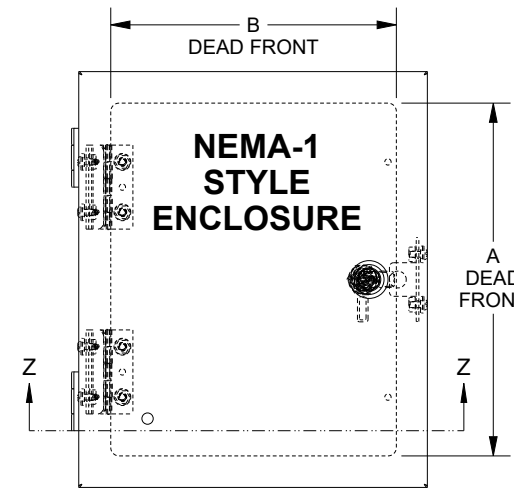

DRILL THRU
Ø0.218 (x4)

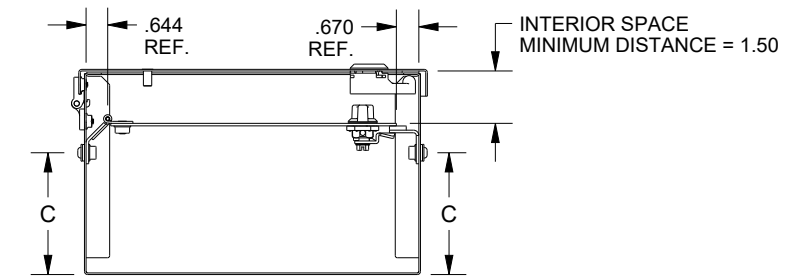

SECTION Z-Z

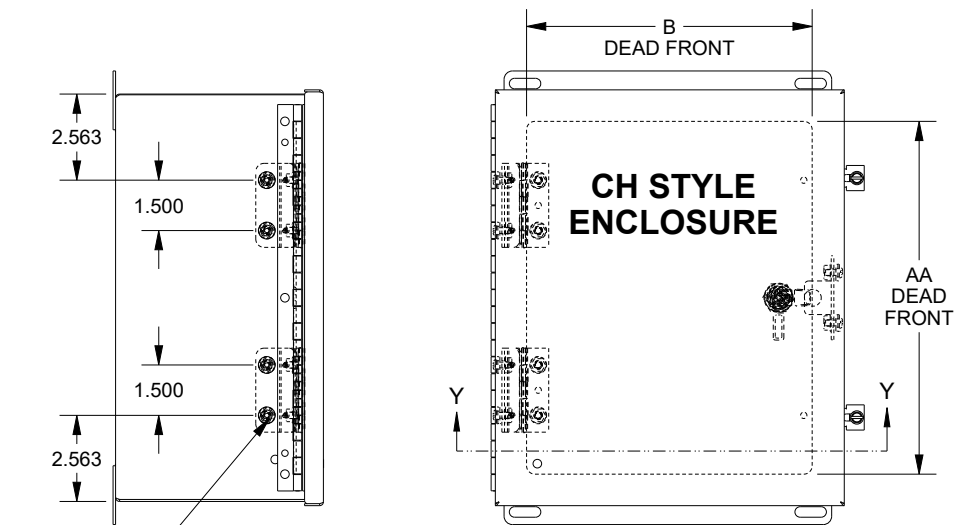

DRILL THRU
Ø0.218 (x4)

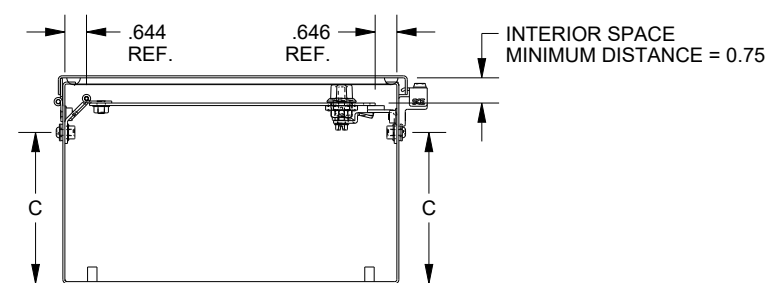

SECTION Y-Y

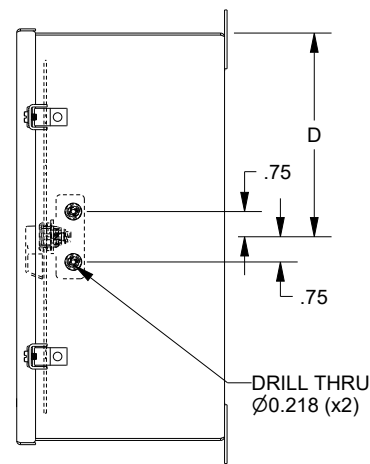

DRILL THRU
Ø0.218 (x2)

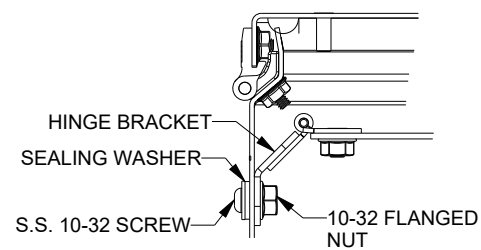

HINGE SIDE INSTALLATION DETAIL
TYPICAL FOR ALL ENCLOSURES
DO NOT SCALE

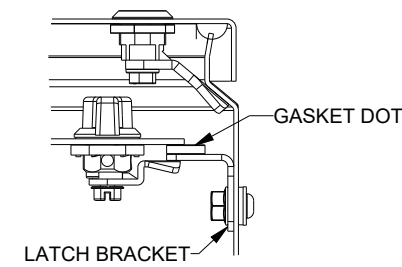

LATCH SIDE INSTALLATION DETAIL
TYPICAL FOR ALL ENCLOSURES
DO NOT SCALE

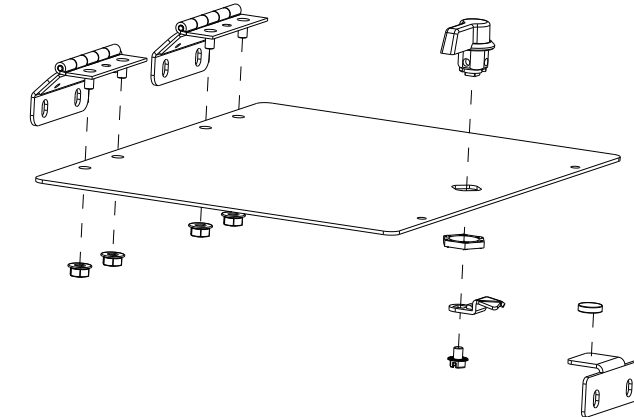

DEAD FRONT EXPLODED VIEW

- A = ENCLOSURE HEIGHT - 1.50**
- AA = ENCLOSURE HEIGHT - 1.63**
- B = ENCLOSURE WIDTH - 1.50**
- C < = ENCLOSURE DEPTH - INTERIOR SPACE - .75**
- D = ENCLOSURE HEIGHT / 2**

BY	REV.	DESCRIPTION OF CHANGES	DATE
REVISIONS			

SAGINAW CONTROL & ENGINEERING

FILE: CH-ELJ-DF-SPEC-INST-2

REVISION: 1

SHEET: 1 OF 1

