

# SAGINAW CONTROL & ENGINEERING

## SCE-NADFKSS

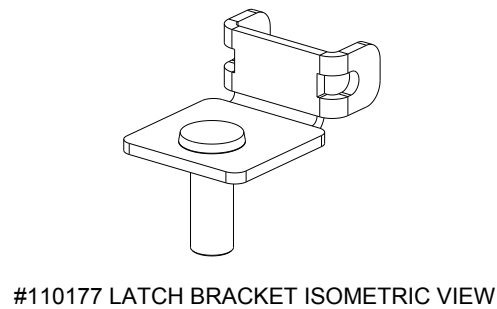
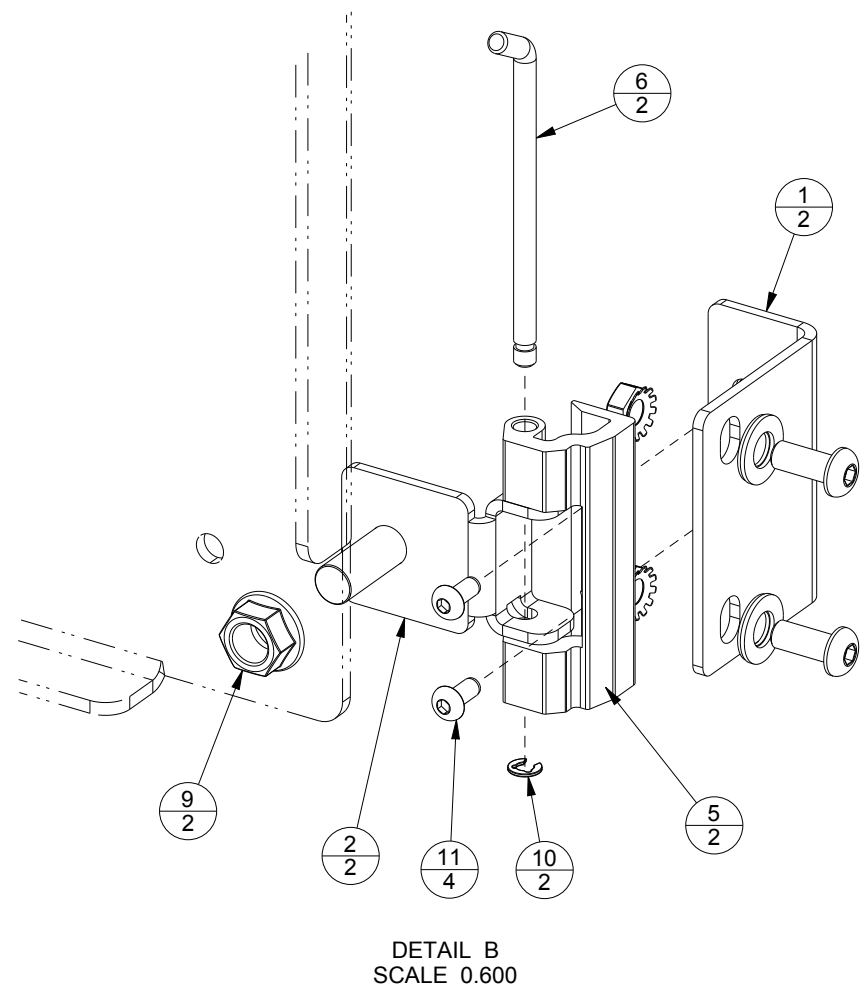
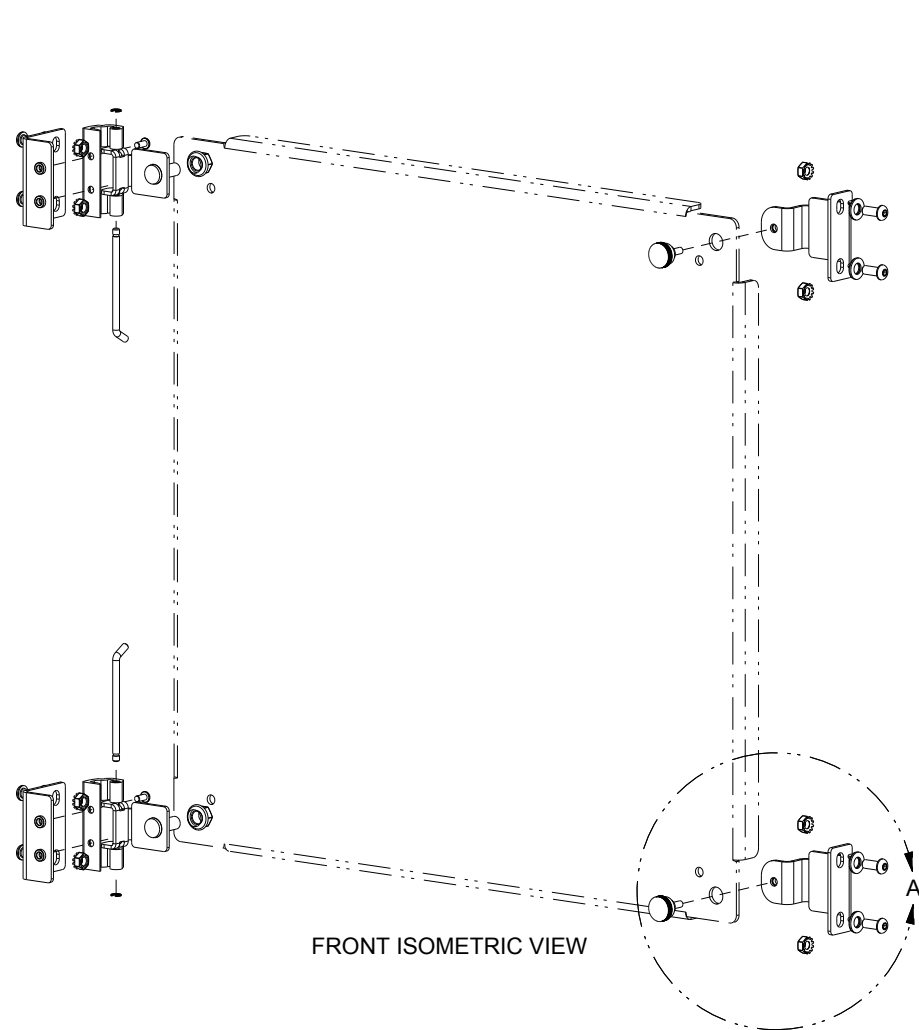
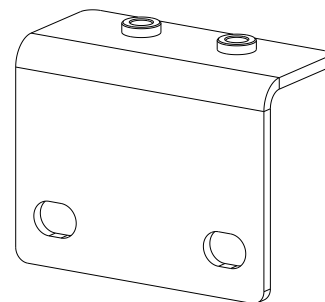
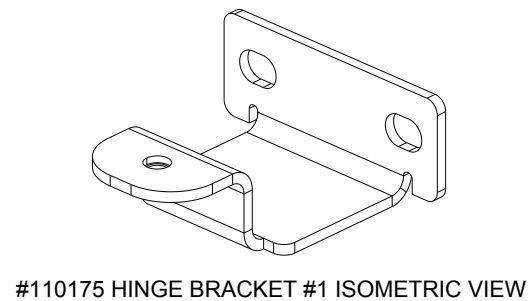
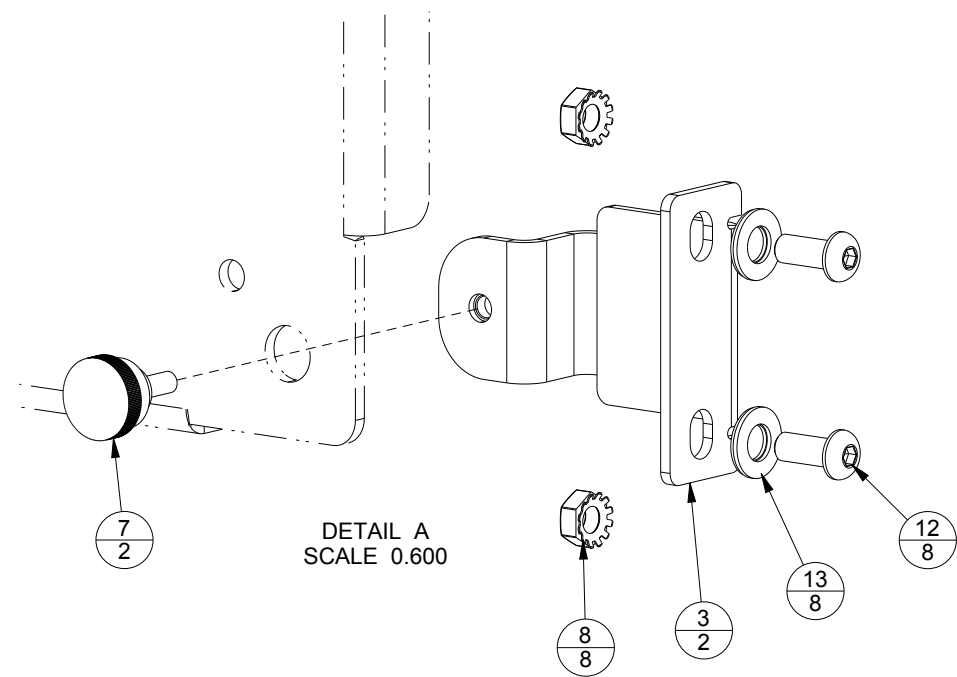
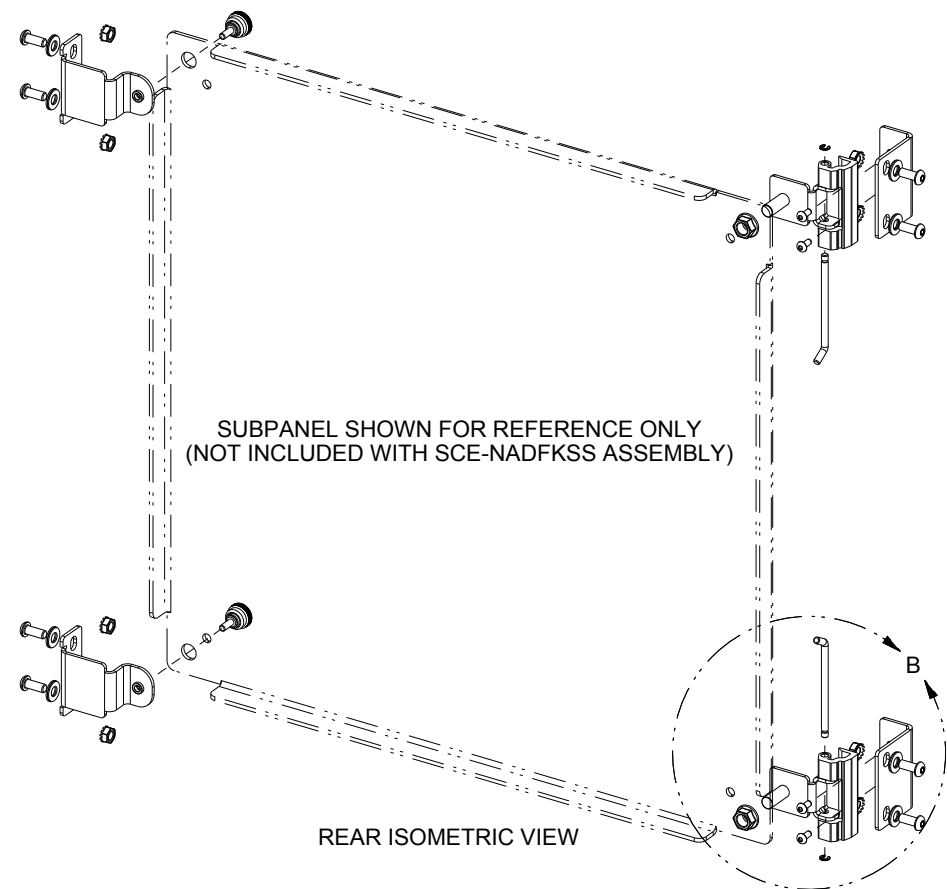

BILL OF MATERIAL			
ITEM	QTY	PART DESCRIPTION	PART I.D.
1	2	SCE-NADFKSS Swing Panel Hinge Bracket-1 Assembly	110176
2	2	SCE-NADFKSS Swing Panel Hinge Bracket-2 Assembly	110177
3	2	SCE-NADFKSS Swing Panel Latch Bracket Assembly	110175
4	1	Bolt Pack, SCE-NADFK Swing Panel Kit	110174

BOLT PACK #110174 BILL OF MATERIAL			
ITEM	QTY	PART DESCRIPTION	PART I.D.
5	2	Concealed Hinge, Small SCE, Zinc Die Cast	101376
6	2	Hinge Pin, Small Concealed, Stainless Steel	101226
7	2	Knob, Knurled, 10-32 x 3/4 dia x 7/8 long, Steel, Zinc	102723
8	8	Nut, Keps, 1/4-20, Steel, Zinc Clear	100877
9	2	Nut, Serrated Flange, 3/8-16 Steel, Zinc Clear Plated	100904
10	2	Retainer, E-Clip, 0.03"Thick X 0.16" ID X 0.35" OD, Stainless	101670
11	4	Screw, Button Head Torx, 10-32 X 3/8", Stainless	102483
12	8	Screw, Button Head, Socket, 1/4-20 X 5/8, Stainless	102532
13	8	Washer, Sealing, 0.63 x 0.33, Steel w/Neoprene, Galvanized	107973