

# SAGINAW CONTROL & ENGINEERING

## SCE-MINQ, PART I.D. 100938

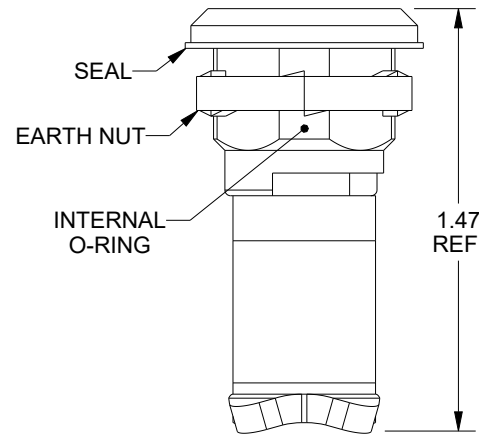

TO MAINTAIN TYPE  
3, 3R, 4, 4X & 12

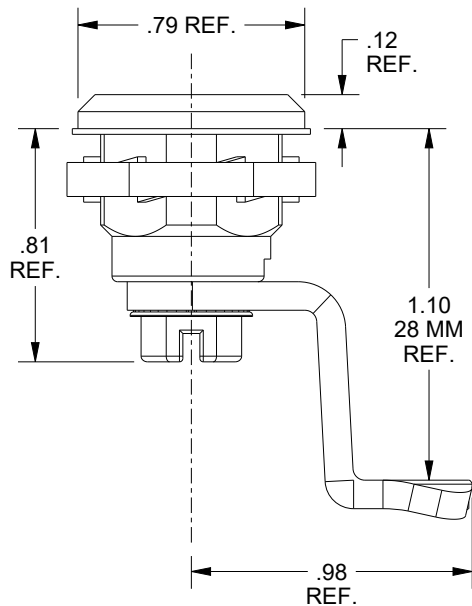
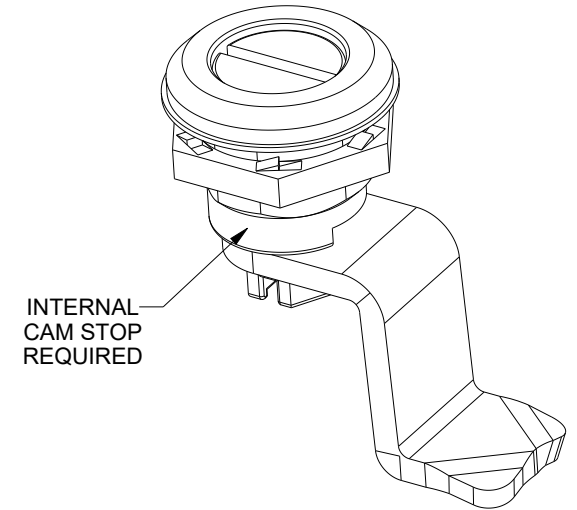
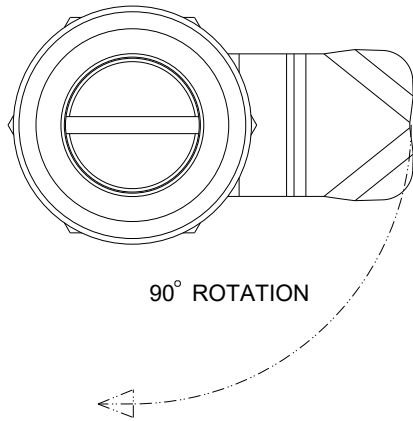
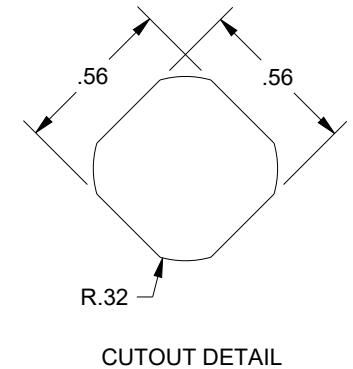

DESCRIPTION:  
MINIATURE QUARTER TURN, SLOTTED INSERT,  
INTERNAL CAM STOP, CAM INCLUDED 28 MM.  
ZINC DIE CAST, CHROME PLATED