

The diagram shows three identical rectangular blocks placed side-by-side on a horizontal surface. Each block has a dashed line at its base, indicating a specific height or position. The blocks are arranged in a row, with equal spacing between them.

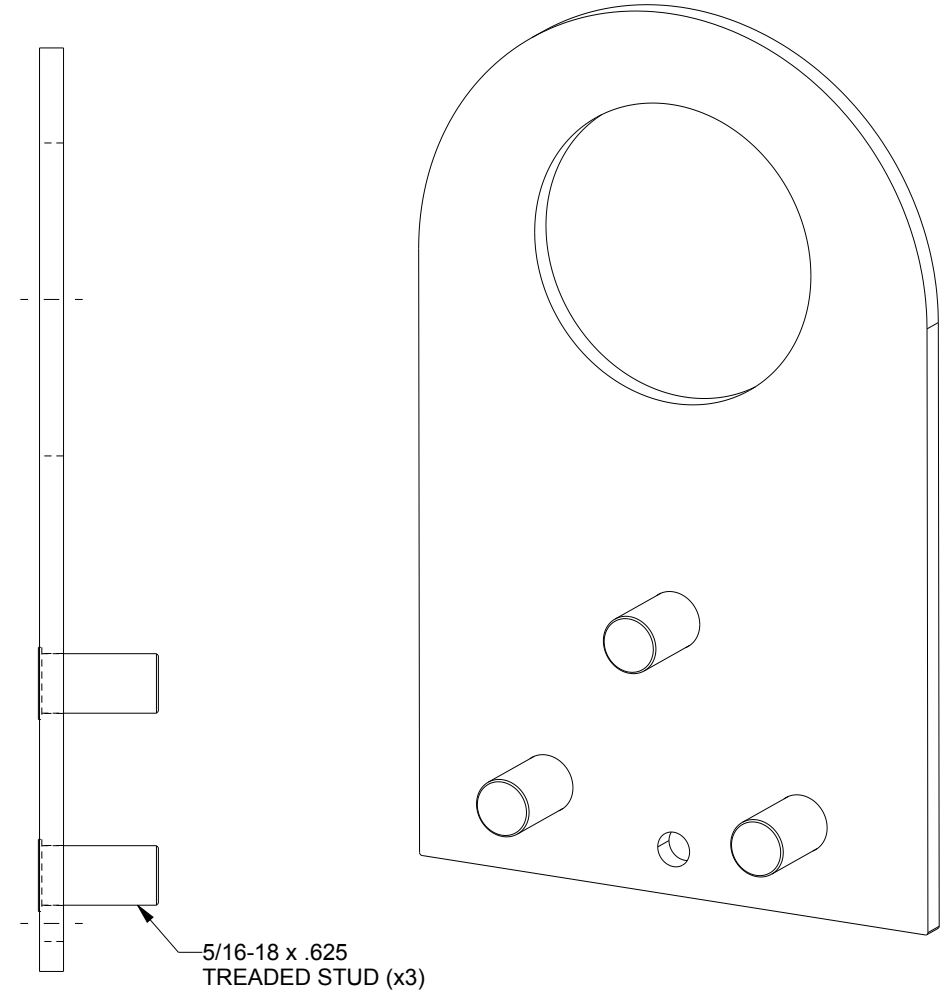

BILL OF MATERIAL			
ITEM	QTY	PART DESCRIPTION	PART I.D.
1	50	Lifting Eye, Pemmed, Steel Zinc Plated	117673
2	25	Bolt Pack, 0.31-18 Nut W/ Sealing Washer (6 Pck) Zinc Plated	118457