

# SAGINAW CONTROL & ENGINEERING

## SCE-DL7TE

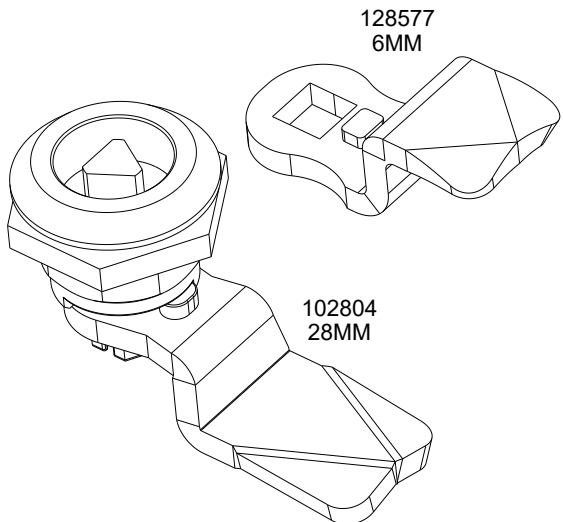

EXTERNAL CAM STOP  
IS REQUIRED

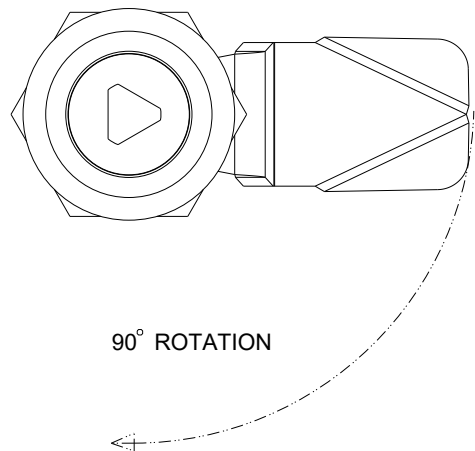
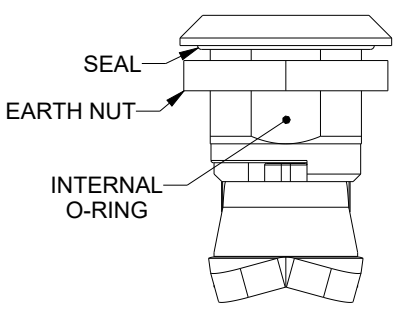
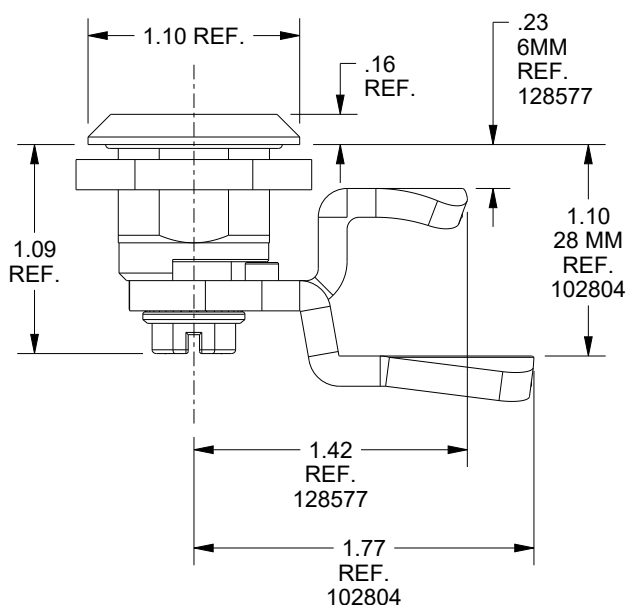

TO MAINTAIN TYPE  
3, 3R, 4, 4X & 12

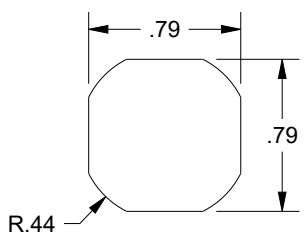

CUTOUT DETAIL

DESCRIPTION:  
QUARTER TURN, 7 MM TRIANGULAR INSERT W/ KEY,  
EXTERNAL CAM STOP, 28MM AND 6MM CAMS INCLUDED.  
ZINC DIE CAST, CHROME