

SCE-3PTL 3-POINT LATCH KIT BILL OF MATERIAL

| ITEM | QTY | PART DESCRIPTION | PART I.D. |
|------|-----|---|-----------|
| 1 | 2 | Nut, Lock, Nylon Insert, 1/4-20, Steel, Zinc Clear | 100879 |
| 2 | 2 | Door Rod, 8mm Round Rod w/Rollers, 1200mm, Steel, Zinc | 101380 |
| 3 | 1 | Cam, 3 Point, Dual, Small Door Center, Steel, Zinc Clear | 102232 |
| 4 | 2 | Rod Guide, 1/4 Turn Mtg. Guide For Round Rod, Steel, Zinc | 102253 |
| 5 | 2 | Adapter, 0.312 Rnd Rod, Zinc Die Cast, with Screw | 102643 |
| 6 | 1 | Washer, Flat, 0.31 in, 0.75 O.D. x 0.34 I.D., Stainless | 105004 |
| 7 | 1 | Door Center Adapter with Stop, 0.79 x 0.25, Zinc Die Cast | 116470 |

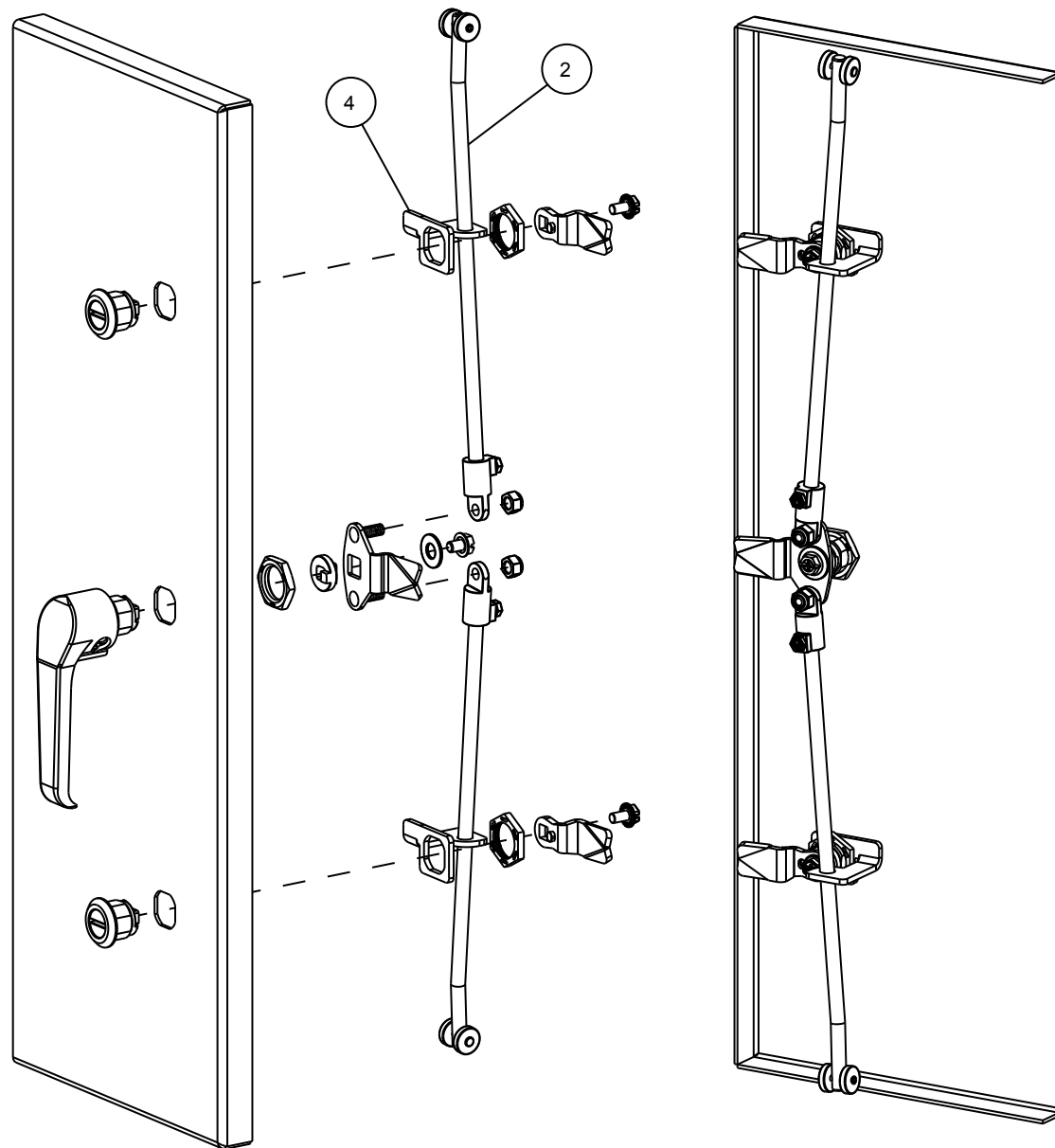
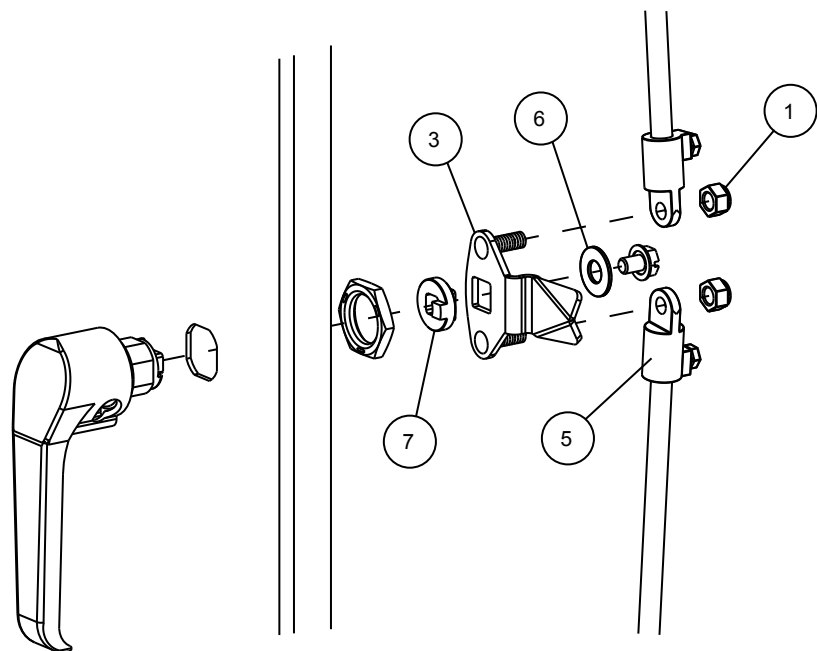

INSTALLATION INSTRUCTIONS:

1. MEASURE THE DISTANCE BETWEEN THE QUARTER TURN LATCHES ON DOOR. DIMENSION "A" + 3 5/8 EQUALS THE DOOR ROD LENGTH.
2. REMOVE THE MOUNTING NUTS FROM THE 1/4 TURN LATCHES.
3. INSERT DOOR ROD THROUGH THE ROD GUIDE AS SHOWN, INSERT ROD GUIDE ONTO QUARTER TURN LATCH AND SECURE MOUNTING NUT.
4. INSTALL CENTER DOOR HANDLE, OR LATCH AND INSTALL CENTER CAM.
5. INSTALL ENDS OF DOOR RODS INTO ROD ADAPTERS ON CAM AND TIGHTEN.

ALONG WITH ANY QUARTER TURN LATCH, THE FOLLOWING HANDLES MAY BE USED WITH SCE-3PTL HARDWARE (HANDLE TO BE ORDERED SEPERATELY)

- SCE-ELKL
- SCE-ELPL
- SCE-PH5
- SCE-PCH5
- SCE-PCH5-7SC
- SCE-PKH5
- SCE-PH7
- SCE-PCH7
- SCE-PCH7-7SC
- SCE-PKH7

| | |
|--|---------|
| TITLE: SPEC-3PT-LATCH-KIT-INSTMAN | REV: 01 |
| INSTALLATION, SCE-3PTL 3-POINT LATCH KIT | |
| SHEET: 1 OF 1 | |

SAGINAW CONTROL & ENGINEERING
ISO 9001:2000 Certified Company



Your Enclosure Source®

Corporate Office:
95 Midland Road
Saginaw, Michigan 48638-5770
(989) 799-6871
Fax (989) 799-4524
(800) 234-6871
<http://www.saginawcontrol.com>
E-mail: sce@saginawcontrol.com