

SCE-3PTL 3 POINT DOOR LATCHING KIT FOR ENVIROLINE ENC.

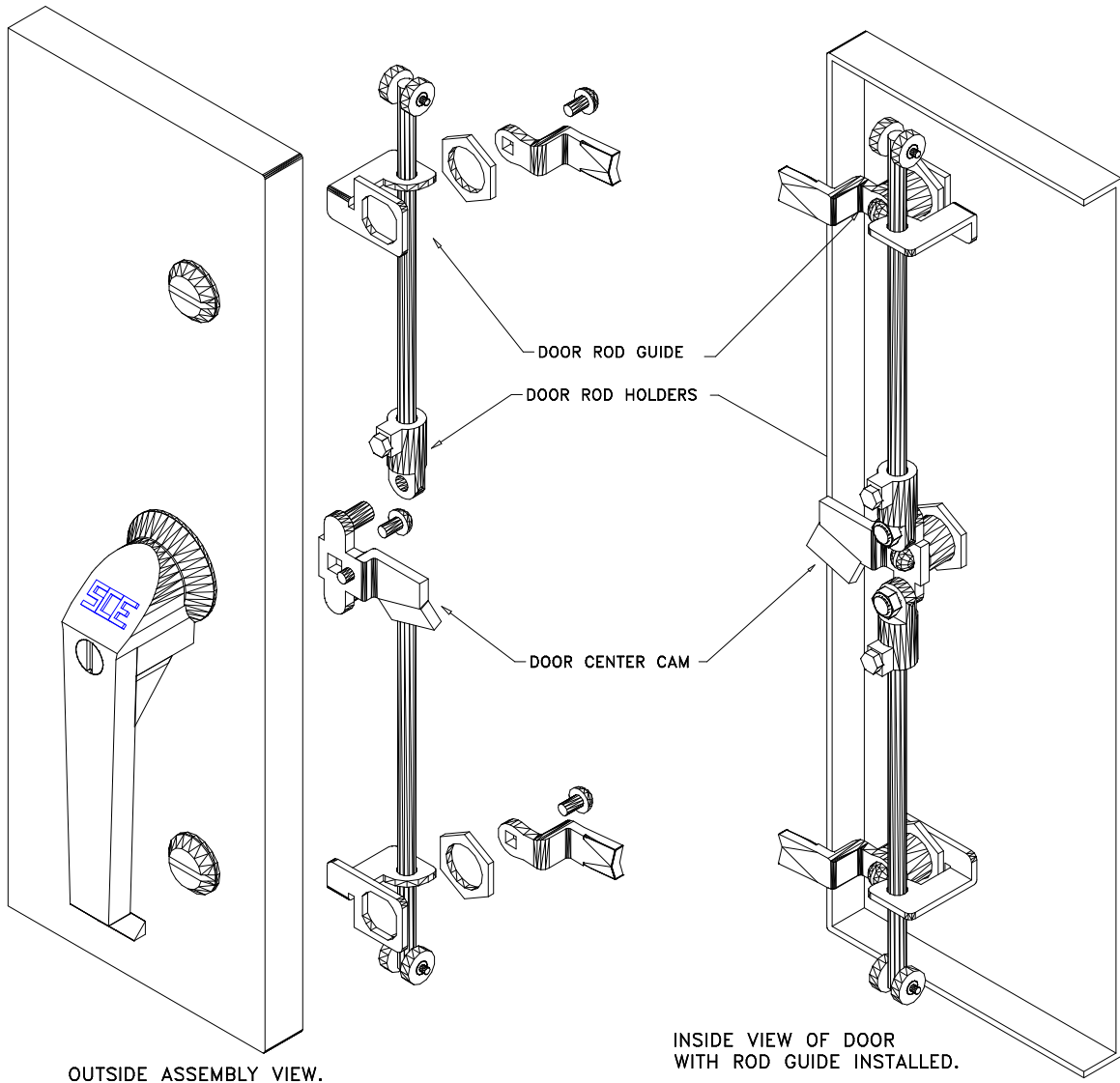

OUTSIDE ASSEMBLY VIEW.

INSIDE VIEW OF DOOR WITH ROD GUIDE INSTALLED.

INSTRUCTIONS

1: MEASURE DISTANCE BETWEEN 1/4 TURNS ON DOOR 'DIMENSION R' AND ADD 3-5/8. THIS WILL BE YOUR DOOR ROD LENGTH.

2: REMOVE THE NUTS ON THE 1/4 TURN LATCHES INSIDE DOOR.

3: BEFORE PUTTING ON DOOR ROD GUIDE, PUT DOOR ROD THROUGH THE GUIDE AS SHOWN ON PRINT. THEN INSERT ROD GUIDE ON 1/4 TURN AND TIGHTEN NUTS.

4: INSTALL DOOR HANDLE (IF CHANGING) AND INSTALL DOOR CENTER (CAM) ON HANDLE.

5: INSTALL ENDS OF RODS INTO ROD HOLDERS ON DOOR CENTERS AND TIGHTEN.

NOTE:

ALONG WITH ANY 1/4 TURN STYLE LATCHES, THE HANDLES LISTED BELOW WILL ALSO WORK WITH SCE-3PTL (MUST BE ORDERED SEPARATELY).

- SCE-ELKL
- SCE-ELPL
- SCE-PCH5
- SCE-PKH5
- SCE-PH5
- SCE-PCH7
- SCE-PKH7
- SCE-PH7

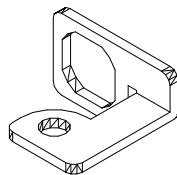

DOOR ROD GUIDE

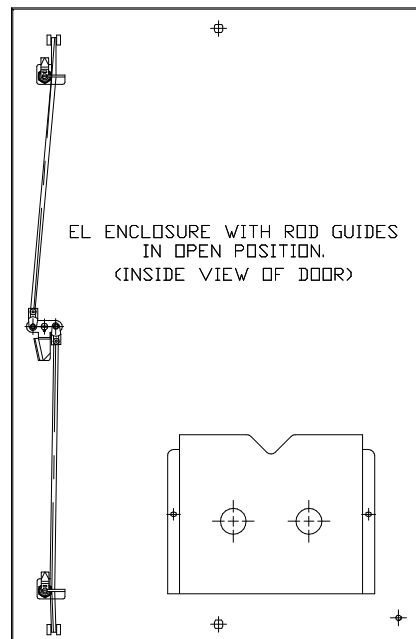

EL ENCLOSURE WITH ROD GUIDES IN OPEN POSITION. (INSIDE VIEW OF DOOR)

