

HEAVY-DUTY PANEL SUPPORTS INSTALL

SCE-60FSHDPS
SCE-72FSHDPS
SCE-90FSHDPS

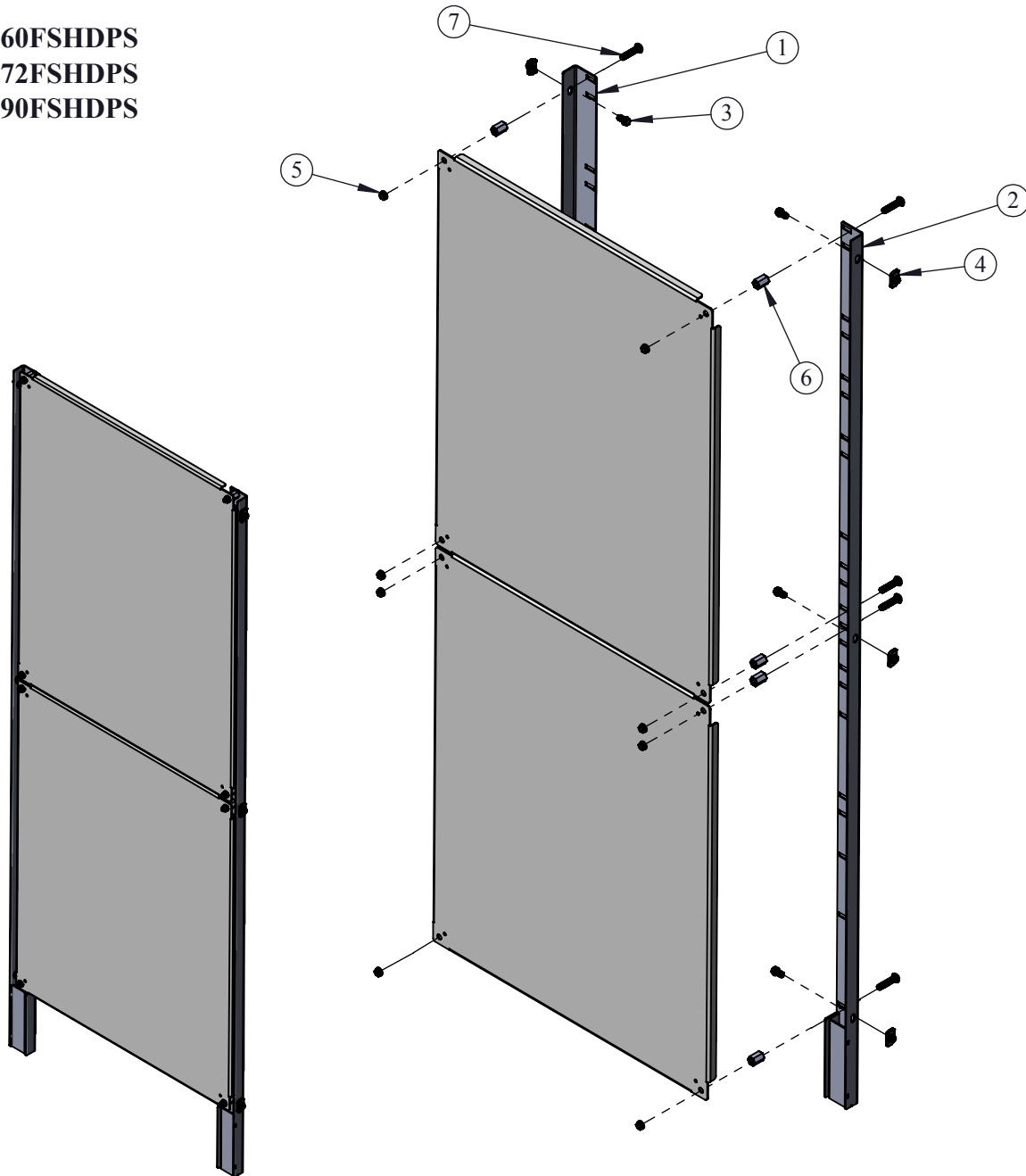

INSTALLATION INSTRUCTIONS

STEP 1: ATTACH HEAVY-DUTY PANEL SUPPORTS (ITEMS 1 & 2) TO MOUNTING CHANNELS INSIDE ENCLOSURE USING CHANNEL NUTS AND BOLTS (ITEMS 3 & 4).

STEP 2: ATTACH COUPLING NUTS AND CARRIAGE BOLTS (ITEMS 6 & 7) TIGHTLY TO PANEL SUPPORT ANGLES WHERE NEEDED. USE 4 PER HALF PANEL, 6 PER FULL PANEL.

STEP 3: INSTALL PANEL(S) USING SERRATED FLANGED NUTS (ITEM 5).



ITEM #	PART NAME	QTY.
1	LEFT SUPPORT	1
2	RIGHT SUPPORT	1
102028	BOLT PACK INCLUDES ITEMS 3-7.	1
3	3/8-16 SERRATED FLANGED BOLT	6
4	3/8-16 CHANNEL NUT	6
5	3/8-16 SERRATED FLANGED NUT	8
6	3/8-16 COUPLING NUT	8
7	3/8-16 X 2 CARRIAGE BOLT	8