

DRIP SHIELD KIT

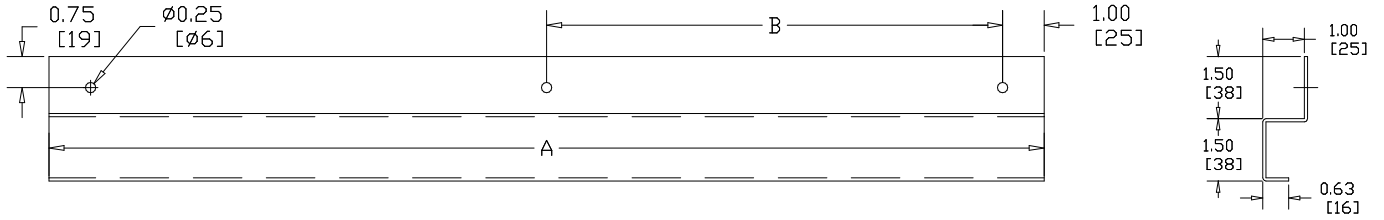

SCE DRIP SHIELD MATERIALS LIST

PART #	A	B	# HOLES	S.S. 10-32 X 0.50 PAN HEAD MACHINE SCREW	S.S. FLAT WASHER FOR 10-32	SEALING WASHER FOR 10-32	3/16 DIA. S.S. HINGE PIN	10-32 HEX NUT	3.5oz. TUBE SEALANT	S.S. SLIDING CLAMP	S.S. SLOTTED H.H. 1/4-28 X 3/4
SCE-DS12	12.00 [305]	10.00 [254]	2	2	2	2	20.00 [508] LONG	2	1	3	3
SEC-DS16	16.00 [406]	7.00 [178]	3	3	3	3	32.00 [813] LONG	3	1	3	3
SCE-DS20	20.00 [508]	9.00 [229]	3	3	3	3	32.00 [813] LONG	3	1	3	3
SCE-DS24	24.00 [610]	11.00 [279]	3	3	3	3	44.00 [1118] LONG	3	1	3	3
SCE-DS30	30.00 [762]	9.31 [237]	4	4	4	4	68.00 [1727] LONG	4	1	3	3
SCE-DS36	36.00 [914]	11.31 [287]	4	4	4	4	68.00 [1727] LONG	4	1	3	3
SCE-DS42	42.00 [1067]	10.00 [254]	5	5	5	5	68.00 [1727] LONG	5	1	0	0
SCE-DS48	48.00 [1219]	11.50 [292]	5	5	5	5	68.00 [1727] LONG	5	1	0	0
SCE-DS60	60.00 [1524]	11.60 [295]	6	6	6	6	68.00 [1727] LONG	6	1	0	0
SEC-DS72	72.00 [1829]	10.00 [254]	8	8	8	8	68.00 [1727] LONG	8	1	0	0

SCE STAINLESS STEEL DRIP SHIELD MATERIALS LIST

PART #	A	B	# HOLES	S.S. 10-32 X 0.50 PAN HEAD MACHINE SCREW	S.S. FLAT WASHER FOR 10-32	SEALING WASHER FOR 10-32	10-32 HEX NUT	3.5oz. TUBE SEALANT
SCE-DS12SS	12.00 [305]	10.00 [254]	2	2	2	2	2	1
SEC-DS16SS	16.00 [406]	7.00 [178]	3	3	3	3	3	1
SCE-DS20SS	20.00 [508]	9.00 [229]	3	3	3	3	3	1
SCE-DS24SS	24.00 [610]	11.00 [279]	3	3	3	3	3	1
SCE-DS30SS	30.00 [762]	9.31 [237]	4	4	4	4	4	1
SCE-DS36SS	36.00 [914]	11.31 [287]	4	4	4	4	4	1
SCE-DS42SS	42.00 [1067]	10.00 [254]	5	5	5	5	5	1
SCE-DS48SS	48.00 [1219]	11.50 [292]	5	5	5	5	5	1
SCE-DS60SS	60.00 [1524]	11.60 [295]	6	6	6	6	6	1
SEC-DS72SS	72.00 [1829]	10.00 [254]	8	8	8	8	8	1

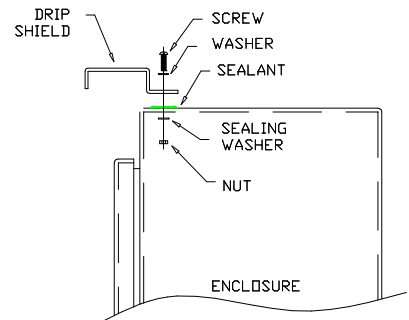

INSTALLATION INSTRUCTIONS

1. REMOVE HINGE PIN AND SLIDING CLAMPS ON NEMA 12 ENCLOSURES AND REPLACE WITH STAINLESS PARTS.
2. DRILL HOLES IN ENCLOSURE.
3. APPLY SEALANT TO EXTERIOR OF ENCLOSURE.
4. INSTALL DRIP SHIELD WITH HARDWARE INCLUDED.