

# SCE CABLE INTERLOCK

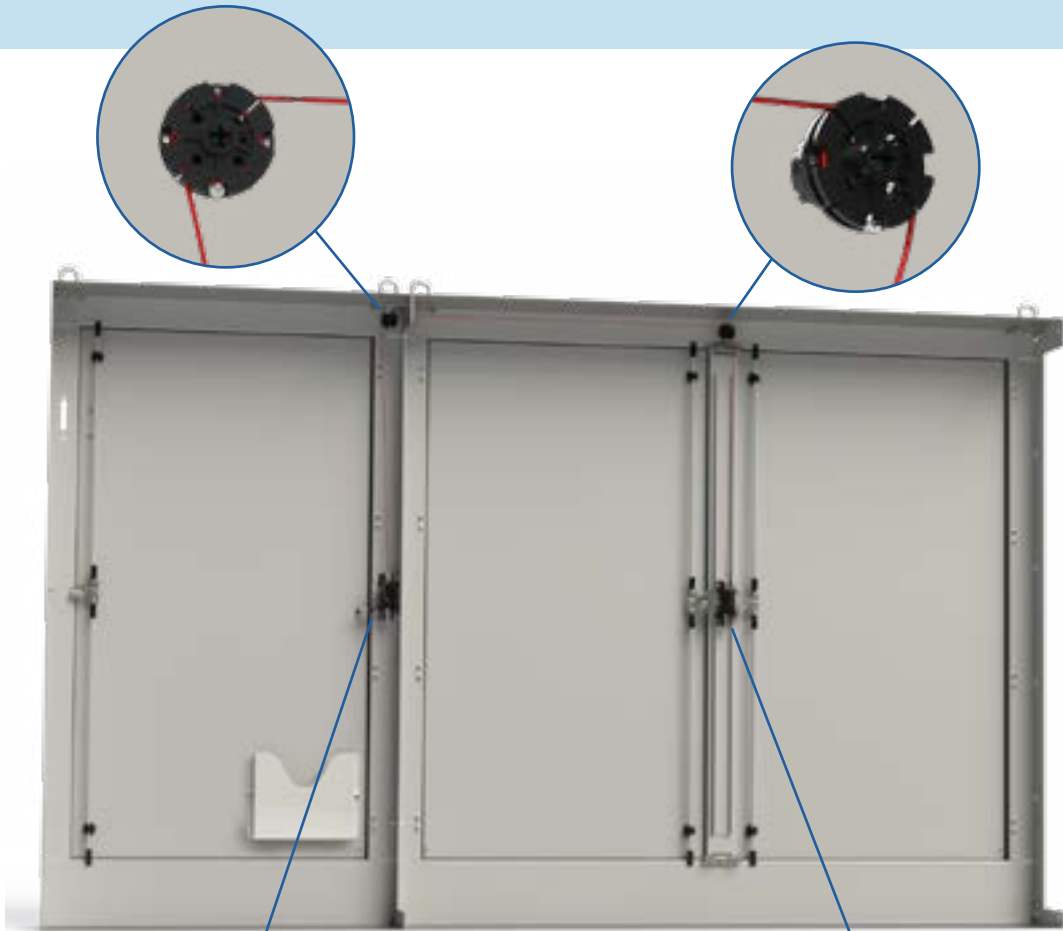

Visit the online pdf  
for a link to the  
video installation

Back View  
\*Enclosure back  
removed and cable  
shown in red for  
visual aid.\*



Primary Interlock

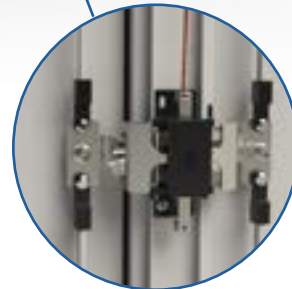

Secondary Interlock



## Interlock Bolt Pack BOM

Item #	Part ID 130518 Qty	Part ID 130520 Qty	Description
1	2	2	Phillips Blunt Screw - 8 X 0.38
2	168"	132"	Cable assembly
3	2	2	Mechanical Interlock - Cable Pulley Base
4	2	2	Mechanical Interlock - Cable Pulley
5	2	2	Door Rod Guide Base
6	2	2	Phillips Machine Screw - 10-32 X 0.50
7	2	2	Flange Nut - Serrated - 0.25-20

## Tools Needed:

Wire Cutter  
7/16 socket/ nut driver  
3/8 socket/ nut driver  
#2 Phillips screw driver  
1/8" dia. pin or punch

Find additional help from the video found at [saginawcontrol.com](http://saginawcontrol.com)

## Installation

**Step 1:** Ensure interlock is being installed in correct orientation. For primary interlock, actuating lever should be on the bottom of interlock. For all secondary interlocks, actuating lever should be on top of interlock.

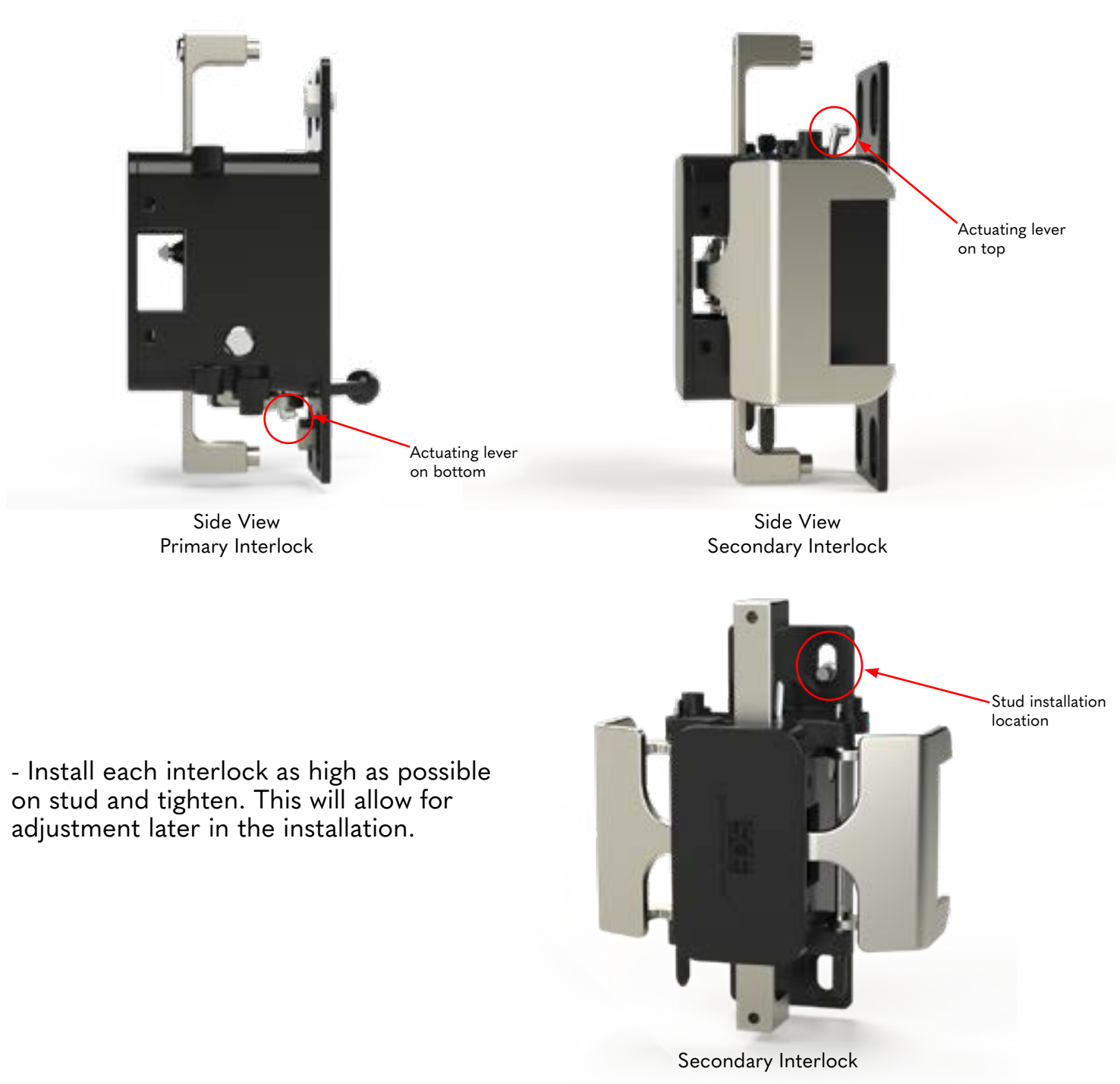

## Step 2: Install pulley above each interlock

- Put Door Rod Guide Base (Item 5) on Threaded Stud, flat part should be horizontal. Install and tighten Nut (Item 7).
- Slide Pulley Base (Item 3) onto Door Rod Guide Base (Item 5).
- Push Pulley (Item 4) onto Pulley Base (Item 3) and snap into place.
- Turn Pulley (Item 4) counterclockwise until hitting the set point. (The pulley will not turn past this point.)

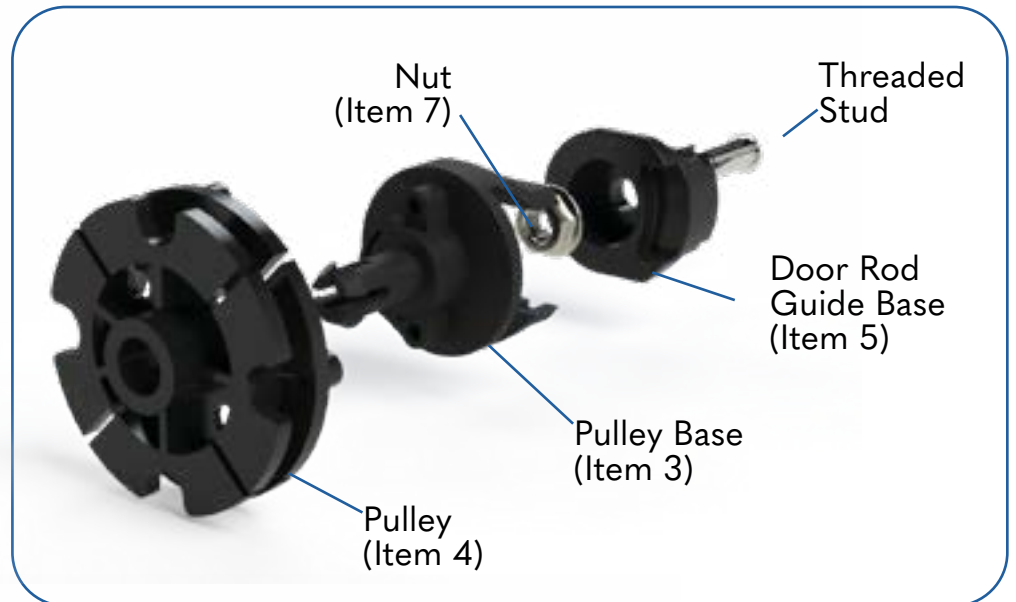

**Step 3:** Cut ball off the end of the cable and insert into primary door interlock. Leave 4" of excess cable for adjustments. Tighten set screw (Item 6).

**Step 4:** Bring the cable up and wrap once completely around the pulley (A) above the interlock and then completely around the secondary door pulley (B). This path is shown in image below in blue arrows. Turn the pulleys counter-clockwise fully. This will help get in the proper position for step 6.

**Step 5:** With the primary door closed and the control arm fully depressed, pull the cable through secondary door interlock. Engage the secondary door interlock, leaving 4" of excess cable and insert and tighten screw (Item 1) locking the cable into place. The interlock will remain in locked position until end of install or until the primary door is open.

**Step 6:** Ensure the pulleys are in the proper position, turned counter-clockwise until they hit their stop point\*\*, and insert the blunt screws (Item 1) at the bottom of the pulleys. Tighten the screws to ensure the cable will no longer slip on the pulleys.

**\*\* Note:** If needed a 1/8" dia. pin or 1/8" Pin Punch can be inserted into a pulley's alignment hole to insure proper position and hold position during installation.

**Final:** Verify that the interlock is functioning properly by closing all doors and checking that all are locked. Open the primary door and all doors should be free to open. Adjustments can be made by loosening set screw and changing cable length. Finer adjustments made by loosening the nuts and sliding interlock down within the obround to increase tension. Retighten the nuts to finish.

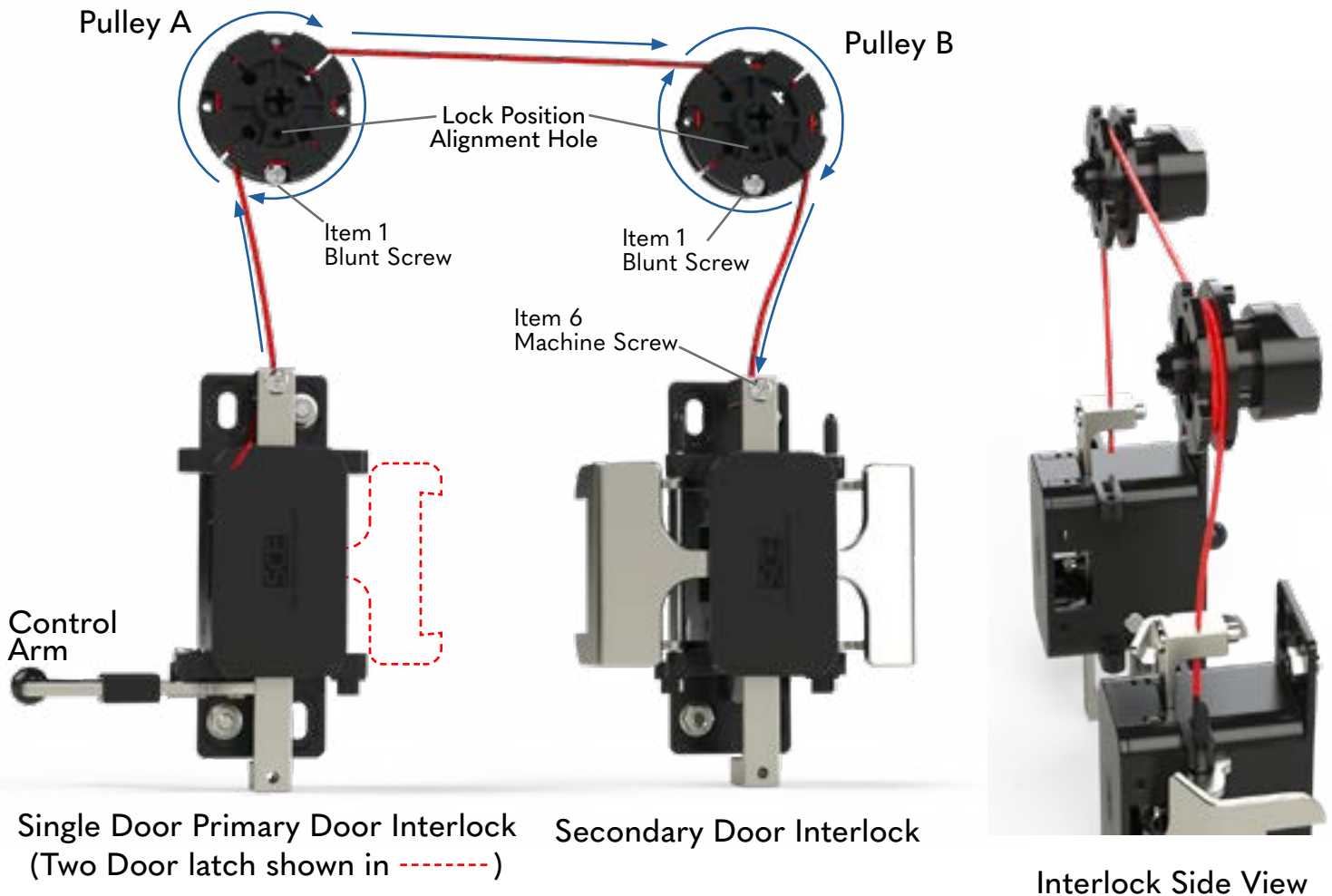

# ADDITIONAL ENCLOSURES

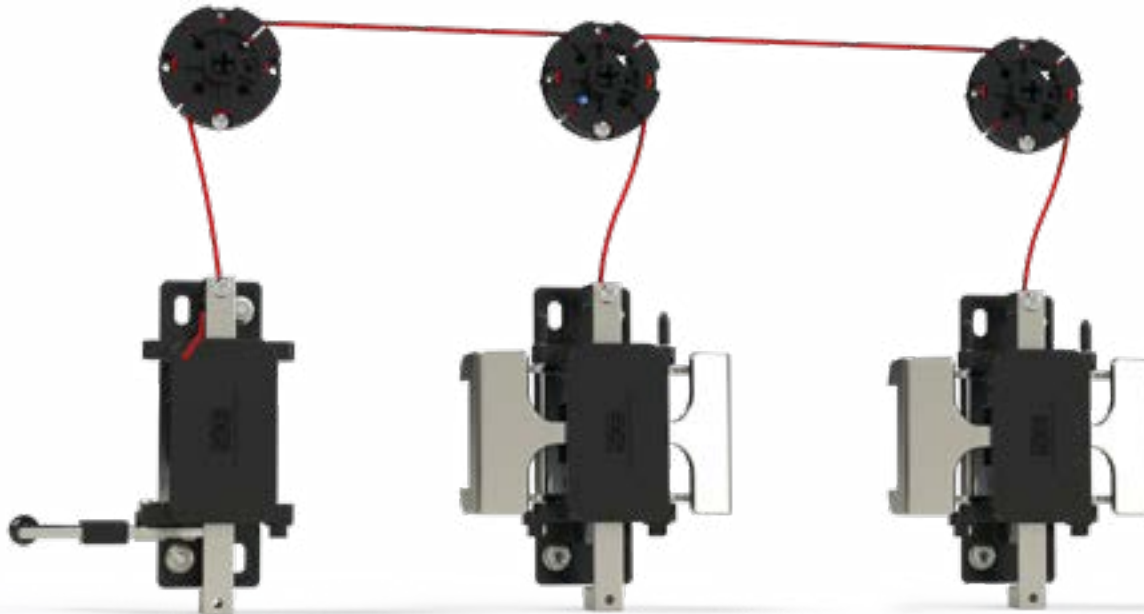

## Adding More Enclosures

- Step 1: Insert cable with ball end (highlighted blue) into previous set pulley. Wrap cable around pulley and bring to next. (Cable path indicated by blue arrows).
- Step 2: Insert screw (Item 1), pull cable tight and tighten screw to secure cable.
- Step 3: Wrap the cable completely around the new enclosure pulley and down into the interlock. Follow instructions from the previous section to ensure the new enclosure is secure. (Currently at step 5)

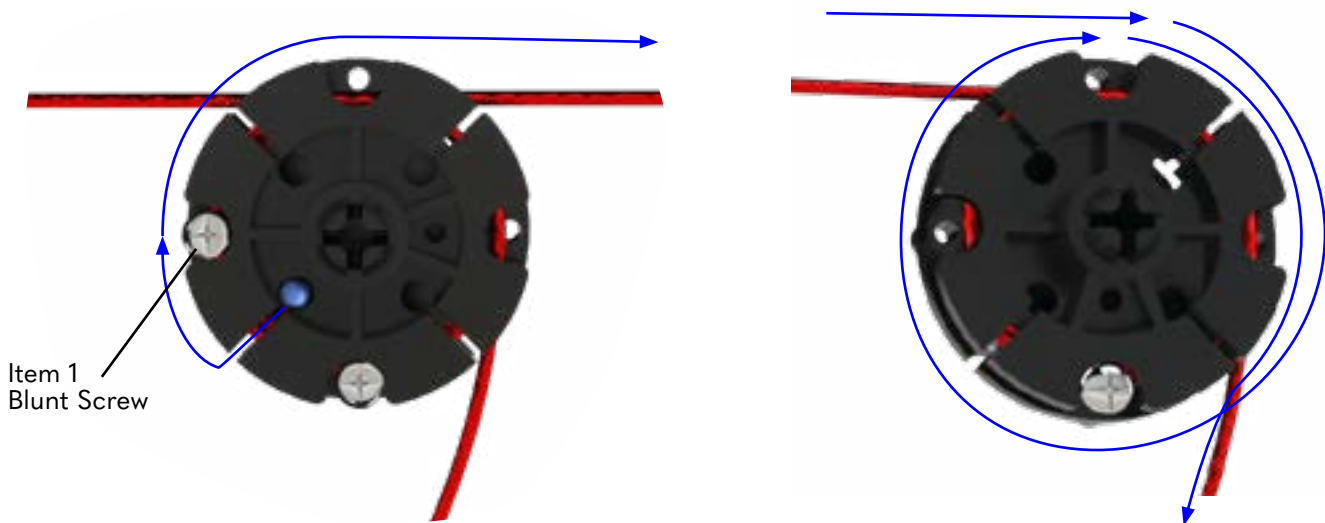

# OVERLAPPING DOORS

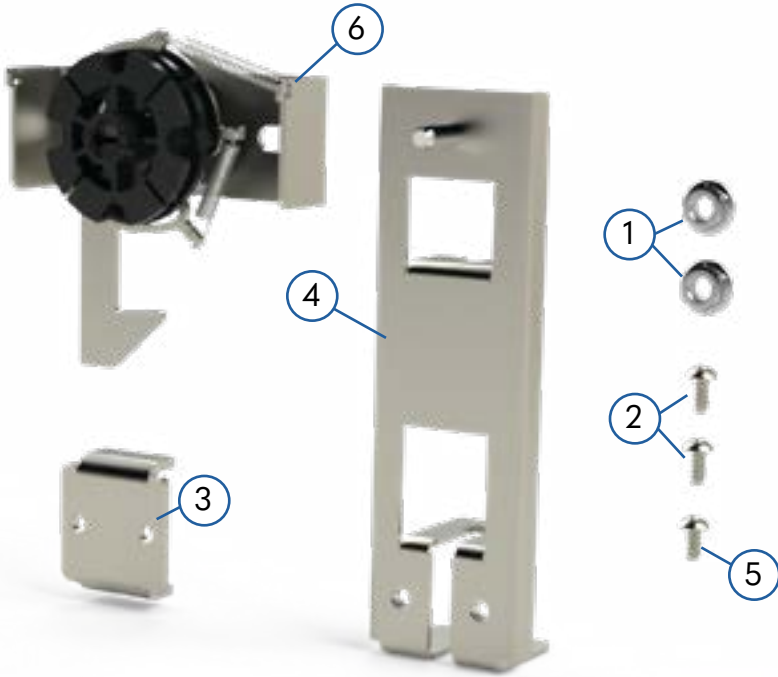

ITEM	QTY	DESCRIPTION
1	2	Flange Nut - 0.25-20
2	2	Pan Head Phillips Screw
3	1	Catch Retainer
4	1	Catch Bracket
5	1	Blunt Screw
6	1	Hook Assembly

## Setting Up Door Catch on Overlapping Door

Step 1: Detach door rod by removing bolt from cam. Place rod through catch (4).

Step 2: Slide the catch up the door rod and align the catch with the hook (See image below).

Step 3: Attached fastener to catch with included screws (2).

Attach the wire similarly to previously done enclosures. With the main door closed, wrap the wire around the pulley in the hook assembly pulley (6). Put the hook into the locked position, with the wire taut, insert and tighten down the blunt screw (5).

Test the door by opening and shutting the main door making sure your overlapping door is locked when closed and unlocked when open.

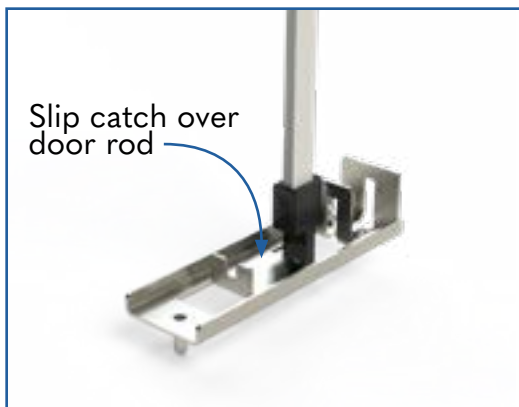

Step 1

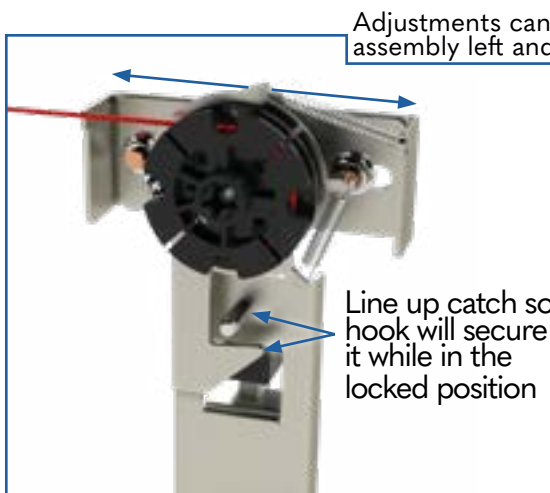

Step 2

Adjustments can be made by moving assembly left and right in the obrounds.

Line up catch so hook will secure it while in the locked position



Step 3